

# KVP<sup>®</sup> Straight 1/2" Pitch Belting SM605 (Smooth Mesh)



Your Source For Habasit  
Belting And Chain

www.StilesEnterprises.com • 1-800-325-4232

## Description

- 1/2 inch pitch
- 30% open area
- Food approved materials
- Bi-directional
- 3/4 inch (19.1 mm) diameter nosebar capability
- Connecting rod diameter = 0.172 inch (4.4 mm)
- Standard belt width increments = 1 inch (25.4 mm) nominal, starting from 2 inches (50.8 mm)
- Non-standard widths available in 1/2 inch (12.7 mm) increments starting at 3 inches (76.2 mm) upon request
- Material selection may affect belt width — please contact your local partner for actual dimensions

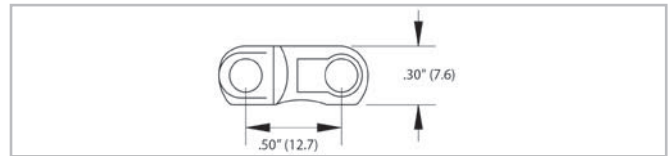
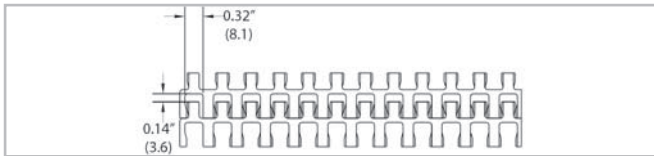
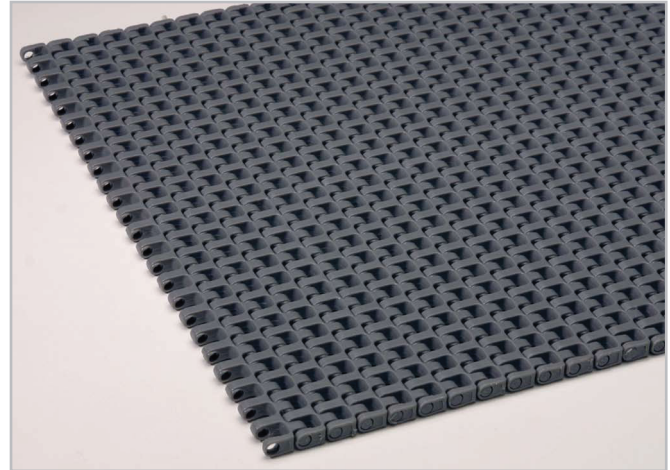

## Belt data

Belt material		PP	PE	POM	Nylon (PA 66)	Nylon (PA +HN)
Rod material		PP	PE	PP		
Nominal tensile strength F' <sub>N</sub>	N/m lb/ft	11675 800	7005 480	20431 1400	20431 1400	10945 750
Temperature range	°C °F	5 - 105 40 - 220	-70 - 65 -94 - 150	5 - 93 40 - 200	5 - 105 40 - 220	-40 - 170 -40 - 338
Temperature maximum (short-term)	°C °F					200 392
Belt weight m <sub>B</sub>	kg/m <sup>2</sup> lb/sqft	4.2 0.86	4.4 0.91	6.1 1.25	5.2 1.06	5.2 1.06
Standard belt color		gray/white	white	blue/white	gray	maroon

Additional belt colors and materials available, abrasive resistant Nylon (Polyamide) rods available – contact your local partner.

## Belt accessories

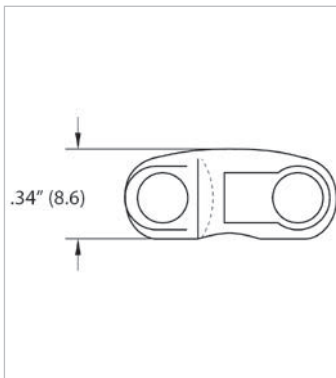

Inserts  
Note: Inserts may affect belt pull - please contact your local partner.

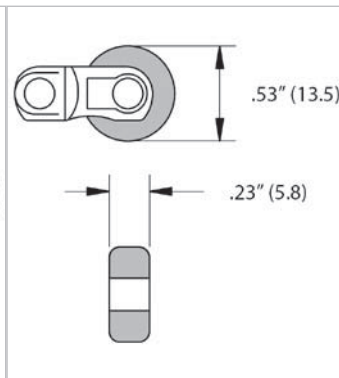

Rollers

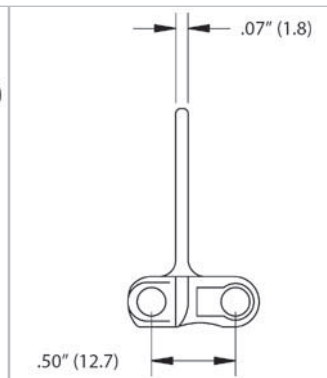

Flights  
Standard flights are available in 1" (25.4 mm) height.

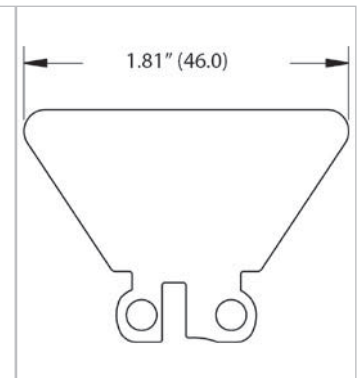

Sideplates  
Sideplates are available in standard 1" (25.4 mm) height.