

# KVP<sup>®</sup> Radius 1/2" Pitch Belting RS515 (Tight Radius Curved Top)



Your Source For Habasit  
Belting And Chain

www.StilesEnterprises.com • 1-800-325-4232

## Description

- 1/2 inch pitch
- Belt turning radius equals 1.1 times the nominal belt width
- 40% open area with reduced product contact
- Food approved materials
- 3/4 inch (19.1 mm) diameter nosebar capability
- Connecting rod diameter = 0.188 inch (4.8 mm)
- Standard belt width increments = 1 inch (25.4 mm) nominal, starting from 12 inches (304.8 mm)
- Maximum recommended belt width is 36 inches (914.4 mm), larger widths — contact your local partner
- Material selection may affect belt width — please contact your local partner for actual dimensions

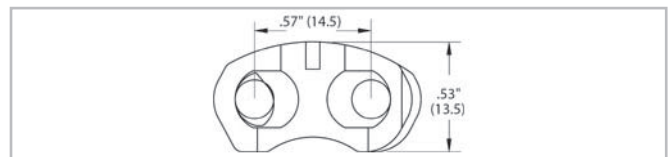
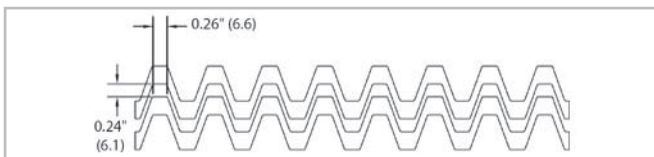
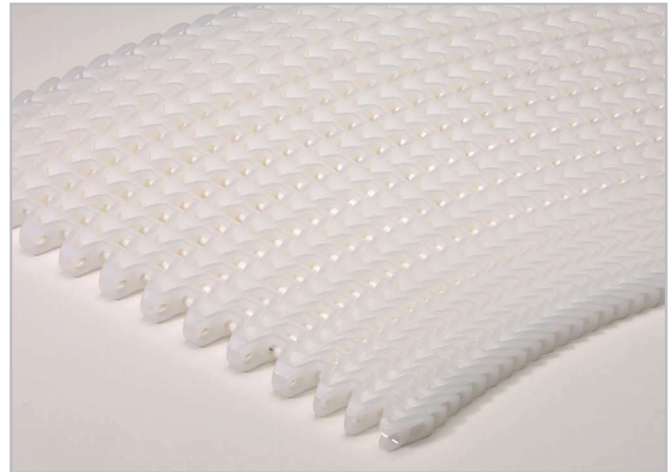

## Belt data

Belt material		POM	Nylon (PA 612)
Rod material		Nylon (PA)	
Nominal tensile strength $F_N$ in curve <sup>(1)</sup>	N lbf	667 150	667 150
Temperature range	°C °F	-40 - 93 -40 - 200	-40 - 118 -40 - 245
Belt weight $m_B$	kg/m <sup>2</sup> lb/sqft	7.2 1.47	5.9 1.21
Standard belt color		blue/white	beige

Additional belt colors and materials available - contact your local partner.

Remark: RS515 belts can not be interlaced with RS505.

## Product liability, application considerations

If the proper selection and application of Habasit products are **not** recommended by an authorized Habasit sales specialist, the selection and application of Habasit products, including the related area of product safety, are the responsibility of the customer.

All indications / information are recommendations and believed to be reliable, but no representations, guarantees, or warranties of any kind are made as to their accuracy or suitability for particular applications. The data provided herein are based on laboratory work with small-scale test equipment, running at standard conditions, and do not necessarily match product performance in industrial use. New knowledge and experiences can lead to modifications and changes within a short time without prior notice.

BECAUSE CONDITIONS OF USE ARE OUTSIDE OF HABASIT'S AND ITS AFFILIATED COMPANIES CONTROL, WE CANNOT ASSUME ANY LIABILITY CONCERNING THE SUITABILITY AND PROCESS ABILITY OF THE PRODUCTS MENTIONED HEREIN. THIS ALSO APPLIES TO PROCESS RESULTS / OUTPUT / MANUFACTURING GOODS AS WELL AS TO POSSIBLE DEFECTS, DAMAGES, CONSEQUENTIAL DAMAGES, AND FURTHER-REACHING CONSEQUENCES.