

HabasitLINK[®] Spiral 1-1/2" Pitch Belting M3843 Tight Radius 1.5"



Your Source For Habasit
Belting And Chain

www.StilesEnterprises.com • 1-800-325-4232

Description

- For radius and straight conveying, ideal for applications with limited space (collapse factor 1.6)
- 37% open area; 50% open contact area; largest opening 9x18 mm (0.35"x0.7")
- Excellent for cooling and draining
- Easy to clean
- Food approved materials
- Rod diameter 6 mm (0.24")
- "Open window" sprockets

Available accessories

- Sideguards

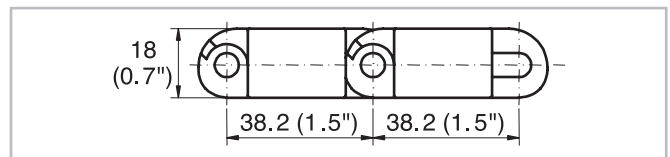

Belt data

Belt material		PP		POM	
Rod material		POM		PA	
Nominal tensile strength F'_N straight run	N/m	20000	20000	29000	
	lb/ft	1370	1370	1986	
Nominal tensile strength F_N in curve ⁽¹⁾	N	1800	1800	2250	
	lbf	405	405	506	
Temperature range	°C	5 - 90	5 - 105	-40 - 90	
	°F	40 - 195	40 - 220	-40 - 195	
Belt weight m_B	kg/m ²	8.0	8.0	11.8	
	lb/sqft	1.64	1.64	2.42	

⁽¹⁾ For $b_0 > 600$ mm (23.6") higher values admissible. Refer to LINK-SeleCalc.

Stainless steel rods are needed in every 4th row if GripTop modules are applied every row (fully covered with rubber).

Use GripTop modules in every second row and M3840 middle modules in the intermediate rows to achieve a sufficient lateral stiffness without using steel rods (in this case the belt weight is around 10% less than the value indicated in the table).

Diameter of idling rollers (minimum)		Diameter of support rollers (minimum)		Diameter for gravity take-up and center drive rollers (minimum)		Backbending radius for elevators without side guards or hold down devices (minimum)		Backbending radius for elevators with sideguards or hold down devices (minimum)	
mm	inch	mm	inch	mm	inch	mm	inch	mm	inch
60	2.4	100	4	150	6	150	6	250	10

Use the largest possible backbending radius for elevators with side guards or hold down devices.