

# KVP<sup>®</sup> Spiral 2" Pitch Belting IS620-R (All-In-One)

## Description

- 2 inch pitch
- Belt turning radius equals 2.2 times the nominal belt width up to 24 inches (609.6 mm)
- Belt turning radius equals 2.5 times the nominal belt width over 24 inches (609.6 mm)
- 75% open area
- Built to USDA & FDA standards
- Bi-directional
- Connecting rod diameter = 0.250 inch (6.4 mm)
- Standard belt width increments = 3 inch (76.2 mm) nominal, starting from 7.25 inches (184.2 mm)
- Non-standard widths available in 1 inch (25.4 mm) increments starting at 5 inches (127 mm) upon request
- Material selection may affect belt width — please contact your local partner for actual dimensions

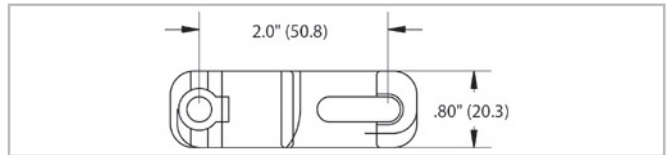
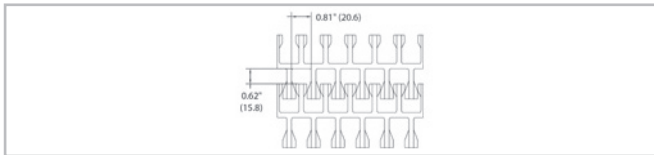
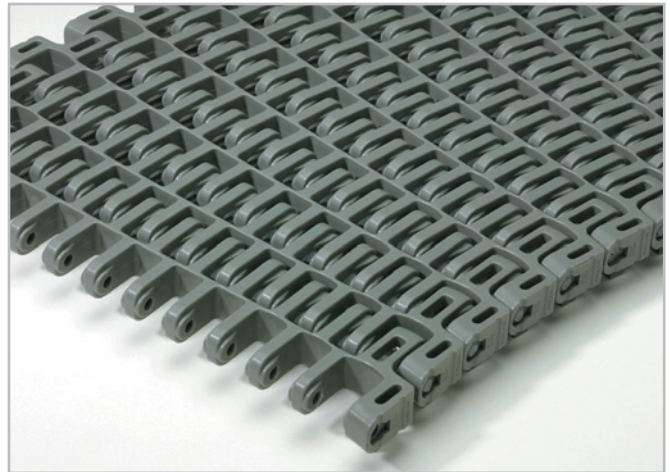

## Belt data

Belt material		PP	PE	POM	Nylon (PA 66)
Rod material		PP	POM	Nylon (PA)	
Nominal tensile strength $F_N$ in curve <sup>(1)</sup>	N	1957	1557	3114	3114
	lbf	440	350	700	700
Temperature range	°C	10 - 99	-40 - 66	-40 - 93	-40 - 118
	°F	50 - 210	-40 - 150	-40 - 200	-40 - 245
Belt weight $m_B$	kg/m <sup>2</sup>	8.6	8.9	12.5	10.5
	lb/sqft	1.76	1.82	2.56	2.15
Standard belt color		gray	white	blue/off-white	dark gray

Additional belt colors and materials available, abrasive resistant Nylon (Polyamide) and stainless steel rods available - contact your local partner.

## Belt accessories

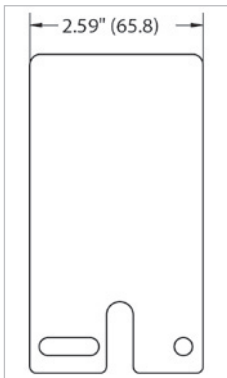

Sideplates  
Available in 4" heights. Note:  
Sideplates must be indented 1  
3/4" from outside edge of belt.